

Plain Grinding-wheels (One Taper-side Grinding-wheels)

Written by YingLong

Friday, 06 October 2006 11:28 - Last Updated Friday, 17 September 2010 17:18

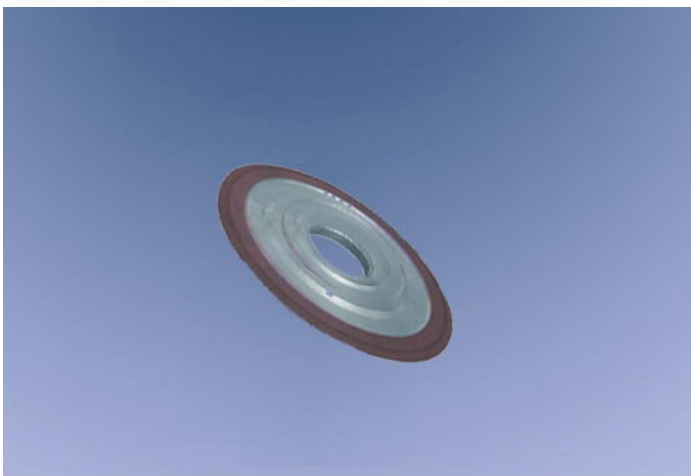
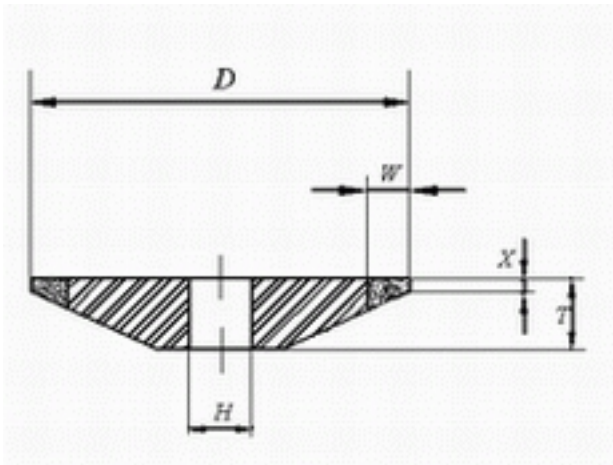

Plain wheels
(One Taper-side wheels)
Code:4B1(PDX)
Binder:B.M(S.Q)
 $a=0.5\text{mm}$

Size (mm)

Plain Grinding-wheels (One Taper-side Grinding-wheels)

Written by YingLong

Friday, 06 October 2006 11:28 - Last Updated Friday, 17 September 2010 17:18

Diamond/CBN Content (carat/piece)

D

T

H

W

50

75

100

75

Plain Grinding-wheels (One Taper-side Grinding-wheels)

Written by YingLong

Friday, 06 October 2006 11:28 - Last Updated Friday, 17 September 2010 17:18

6

10 20

5

2.80

4.20

5.60

100

10

20

5

3.80

5.70

Plain Grinding-wheels (One Taper-side Grinding-wheels)

Written by YingLong

Friday, 06 October 2006 11:28 - Last Updated Friday, 17 September 2010 17:18

7.60

125

10

32

8

10.01

15.02

20.02

150

10

32

8

Plain Grinding-wheels (One Taper-side Grinding-wheels)

Written by YingLong

Friday, 06 October 2006 11:28 - Last Updated Friday, 17 September 2010 17:18

12.81

18.27

24.36